

FCI CONFIDENTIAL

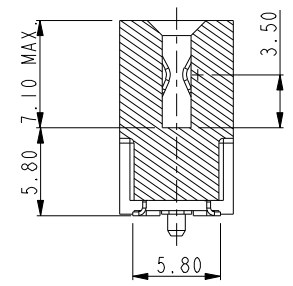

This document is the property of and embodies CONFIDENTIAL and PROPRIETARY information of FCI. No part of the information shown on this document may be used in any way or disclosed to others without the written consent of FCI. Copyright FCI.

PART NUMBER 10058835-1000LF

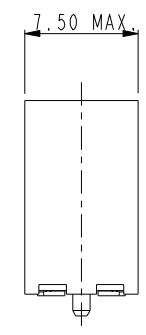
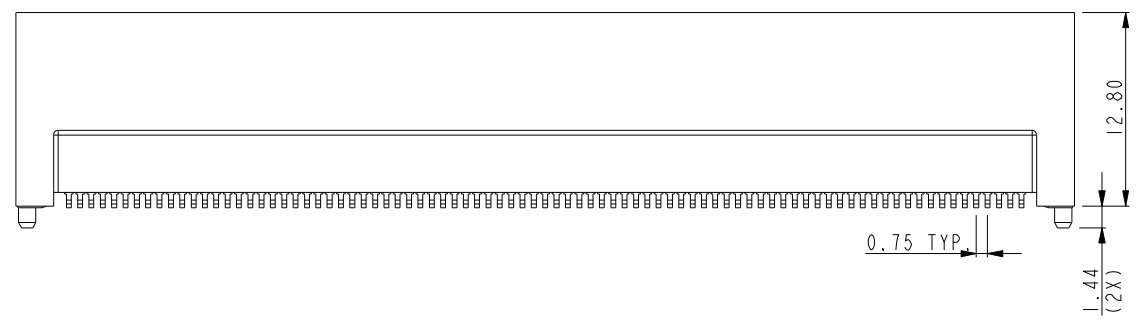
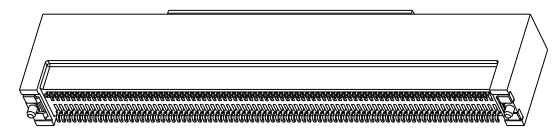
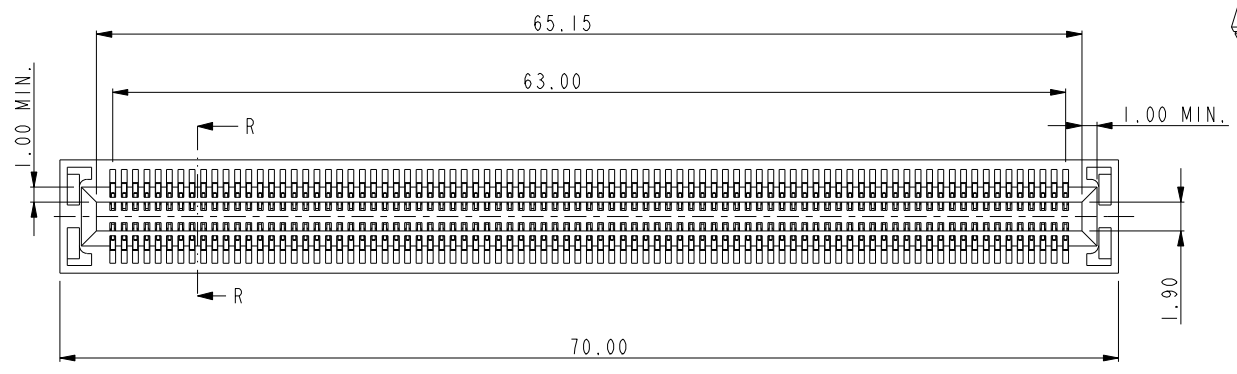

SECTION R-R
SCALE 2.000

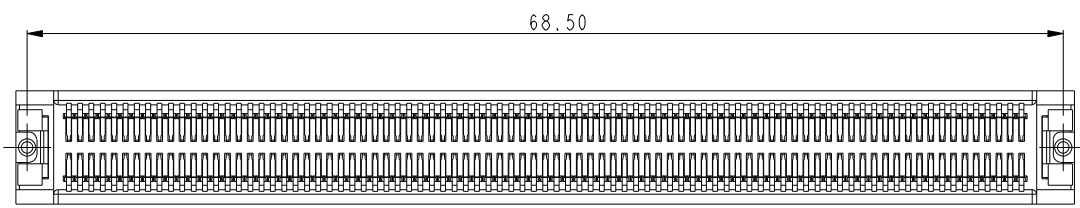

Mark with 10058835 REV. E in area indicated by X.....				Material SEE NOTE		Spec ref *		tolerance		projection		MM		
				Mat code		✓				⊕				
				Heatreat						size A4		Scale 1.000		
				Plating/Finish		Dr MAGGIE WU 2006-01-26								
						Eng ERIC WU 2006-01-26		Product family						
						Chr PAUL WANG 2006-01-26		Model Name 10058835		ECN *				
						Appr JOSEPH HSIA 2006-01-26		Model Revision A		REL Level CONCEPT				
TOLERANCES UNLESS OTHERWISE SPECIFIED														
LINEAR		0.X	±0.3	D	DG07-0067	K	L	2007-02-15						
		0.XX	±0.20	E	DG07-0264	K	L	2007-06-26						
		0.XXX	±0.100	-	-	-	-	-						
ANGULAR		0°	±2°	-	-	-	-	-						
									title SMT TYPE ASS'Y		dwg no 10058835		Rev. E	
									Pro/E file catalog		CUSTOMER		sheet 1 of 5	

FCI CONFIDENTIAL



This document is the property of and embodies CONFIDENTIAL and PROPRIETARY information of FCI. No part of the information shown on this document may be used in any way or disclosed to others without the written consent of FCI. Copyright FCI.

PART NUMBER 10058835-1001LF

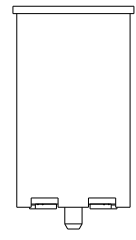
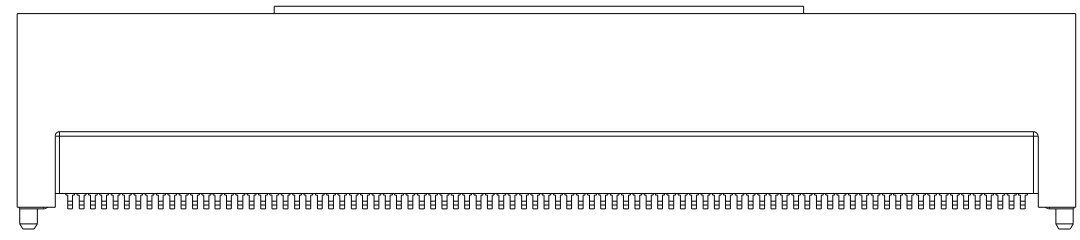
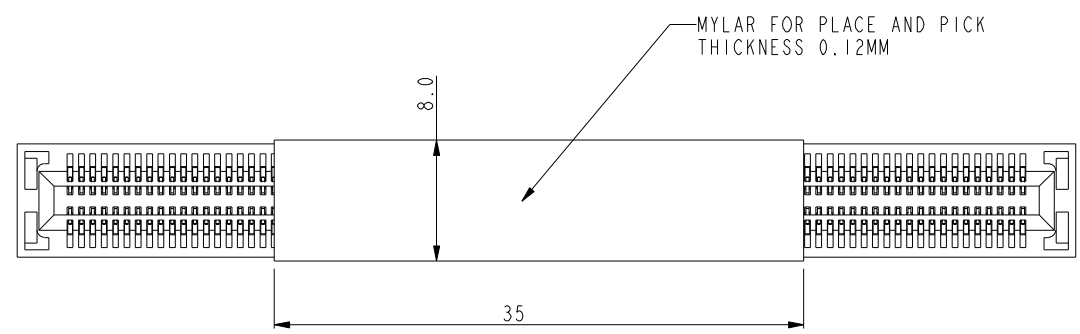

NOTE: ALL THE CONNECTOR DIMENSIONS REFER TO PART NUMBER 10058835-1000LF

Material		SEE NOTE		Spec ref	*			
Mat code				✓	tolerance	projection	MM	
Heatreat								
Plating/Finish								
Dr	MAGGIE WU	2006-01-26				size	A4	
Eng	ERIC WU	2006-01-26	Product family			Scale	1.000	
Chr	PAUL WANG	2006-01-26	Model Name		10058835	ECN	*	
Appr	JOSEPH HSIA	2006-01-26	Model Revision		A	REL Level	CONCEPT	
FCI		title			SMT TYPE ASS'Y		dwg no	10058835
					MICRO TCA		Rev.	E
Pro/E file	catalog	PDM: Rev:E			STATUS: Released		sheet 2 of 5	

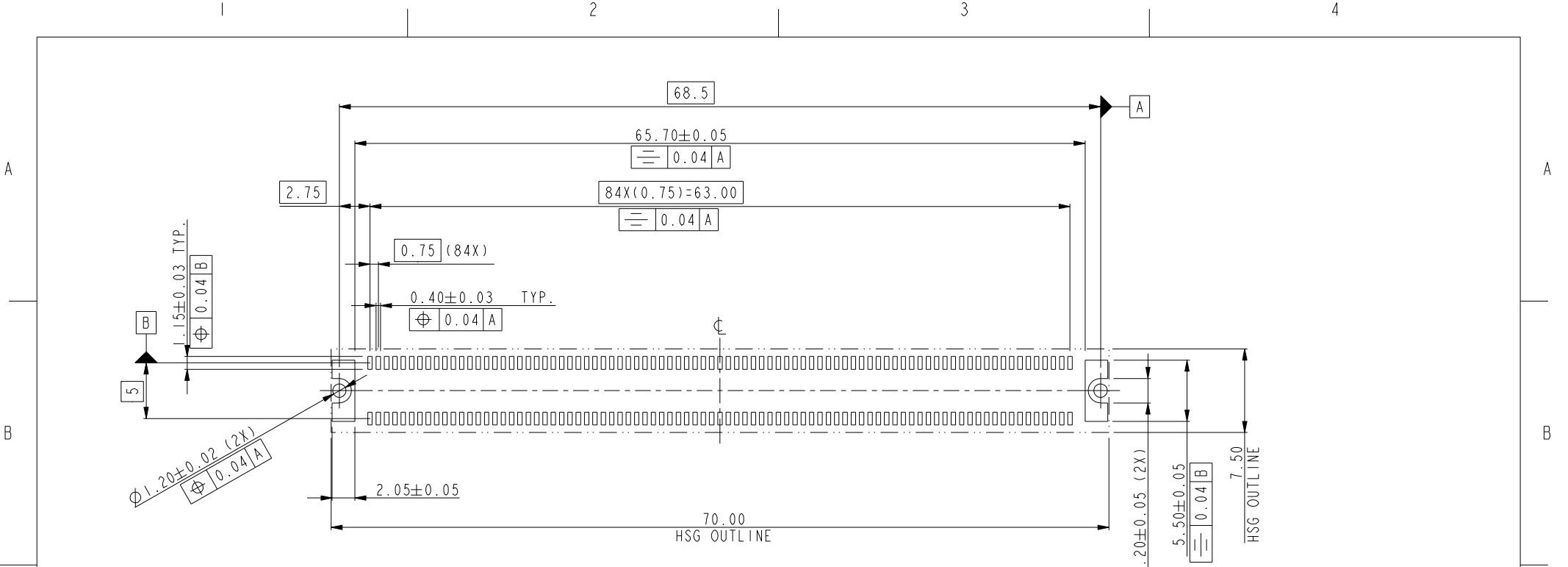

PCB LAYOUT RECOMMENDATION

tolerance unless otherwise specified	
linear	.X ± .3 .XX ± .2 .XXX ± .1
angles	0° ± 2°

Copyright FCI.

 catalog no	SMT TYPE ASS'Y MICRO TCA	dwg no 10058835	Rev. E
	PDM: Rev:E	STATUS: Released	sheet 3 of 5 Printed: Apr 18, 2008

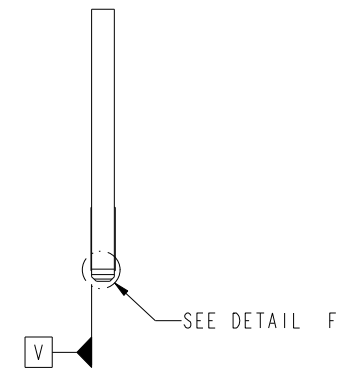
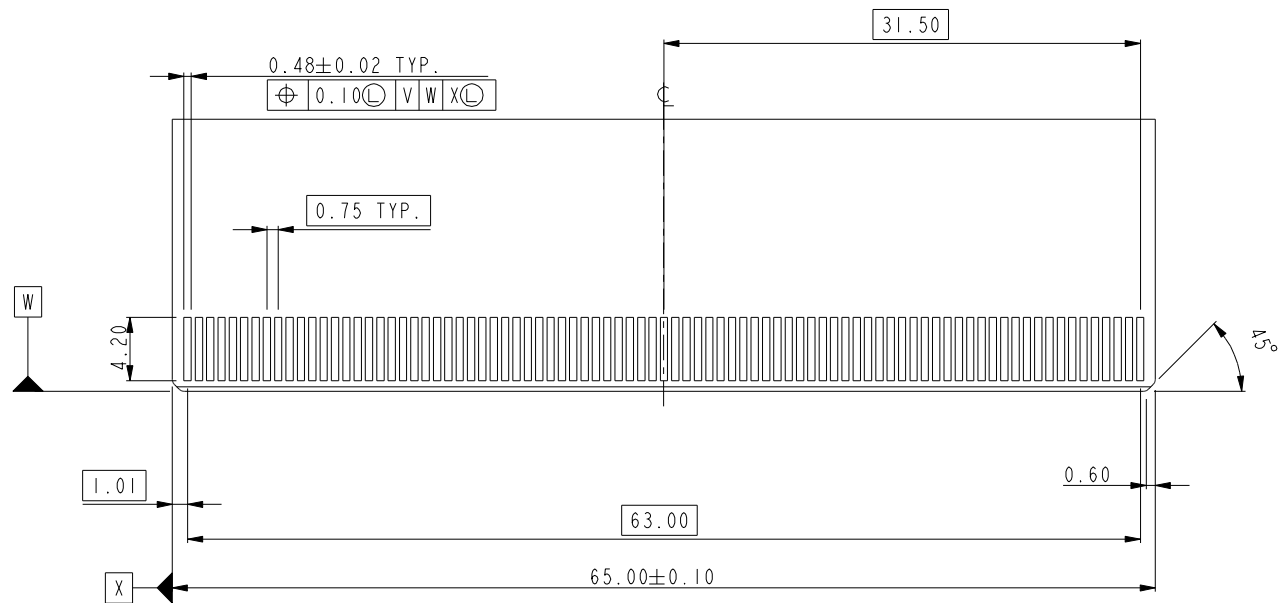

MODULE LAYOUT RECOMMENDATION

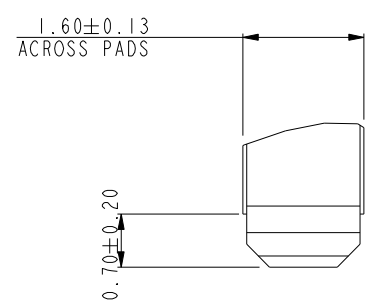

DETAIL F
SCALE 10.000

tolerance unless otherwise specified	
linear	.X ± .3 .XX ± .2 .XXX ± .1
angles	0° ± 2°

Copyright FCI.

	SMT TYPE ASS'Y	dwg no	10058835	Rev.	E
	MICRO TCA	CUSTOMER	sheet 4 of 5	STATUS: Released	

A

B

C

D

A

B

C

D

- NOTES:
1. MATERIAL:
 - HOUSING: HIGH TEMPERATURE, GLASS FILLED UL94V-0 RATED.
 - TERMINAL: COPPER ALLOY
 - PLATING: 1.27um NICKEL UNDERPLATE ALL OVER
 - CONTACT AREA PLATING - SEE PRODUCT NUMBER CODE
 - SOLDER TAIL: MAT TIN - 2.54um MIN.
 - SEE PRODUCT NUMBER CODE
 2. PRODUCT SPECIFICATION: GS-12-362
 3. PACKING SPECIFICATION: GS-14-1047
 4. RoHS COMPATIBLE PRODUCT SPECIFICATIONS
 - a-PLATING:
 - "LF" MEANS THE PRODUCT IS LEAD-FREE, 2um MINIMUM MATTE TIN OVER 1.27um MINIMUM NICKEL UNDERPLATE.
 - b-MANUFACTURING PROCESS COMPATIBILITY
 - THE HOUSING WILL WITHSTAND EXPOSURE TO 260°C±5°C SOLDER BATH TEMPERATURE FOR 5 SECONDS IN A REFLOW SOLDER APPLICATION WITH A 1.6mm MIN THICK CIRCUIT BOARD.

PRODUCT NUMBER CODE
10058835 - X X X X L F

HOUSING COLOR OPTIONS
I-BLACK

PEGS OPTIONS
0-PLASTIC PEGS

TERMINAL PLATING OPTIONS
0-0.76um Au CONTACT AREA

LEAD FREE

RESERVE
0-----WITHOUT MYLAR
I-----WITH MYLAR



Copyright FCI.

tolerance unless otherwise specified	
linear	.X ± .3 .XX ± .2 .XXX ± .1
angles	0° ± 2°

	SMT TYPE ASS'Y	dwg no 10058835	Rev. E
	MICRO TCA		